

DRAWING FOR CUSTOMER

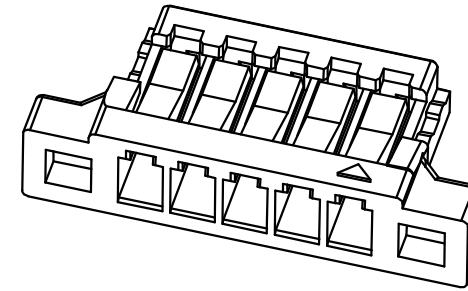

3D View

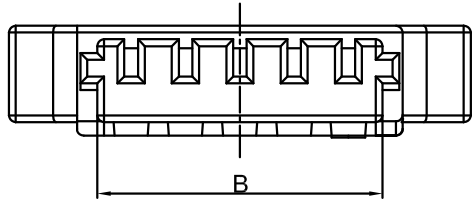
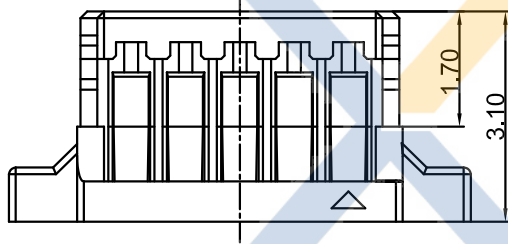

KB802-XXHEXA

Pin No.

Housing

Ear

Version

Mold No.

Dimensions

Pin	A	B	C
2P	0.80	1.80	4.40
3P	1.60	2.60	5.20
4P	2.40	3.40	6.00
5P	3.20	4.20	6.80
6P	4.00	5.00	7.60
7P	4.80	5.80	8.40
8P	5.60	6.60	9.20
9P	6.40	7.40	10.00
10P	7.20	8.20	10.80
11P	8.00	9.00	11.60
12P	8.80	9.80	12.40
13P	9.60	10.60	13.20
14P	10.40	11.40	14.00
15P	11.20	12.20	14.80
16P	12.00	13.00	15.60
20P	15.20	16.20	18.80

■ Specifications:

- Rated Voltage: 30V AC,DC
- Rated Current: 0.5A AC,DC
- Withstand Voltage: 200V AC/minute
- Contact Resistance: 20mΩ, (MAX.)
- Insulation Resistance: 100MΩ, (MIN.)
- Temperature Range: -25°C~+85°C

■ Housing:

- Material: Nylon66 UL94V-0

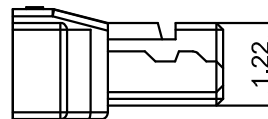
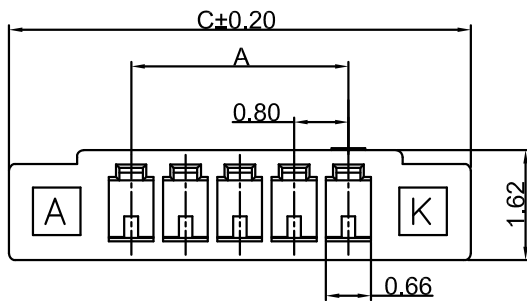

XYCO PRECISION CONNECTORS

TEL: 0769-8297 9981/2/3 <http://www.XYCO.com.cn>

2016-03-30		A			KB802-XXHEXA	譚火秦	TOLERANCE 公差	DRAWING 設計者	譚火秦	KB802-XXHEXA		UNIT 單位		mm	PRODUCT NAME 產品名稱		JST SUH PH0.8 Wire to Board
DATE 日期	VER 版本	CHANGE HISTORY 變更歷史	CHANGED NAME 修改後料號	DRAWING 變更者			.X=±0.30 .XX=±0.20 .XXX=±0.10	CHECKED 審查	彭太坤		PART NO. 料號						Housing ear
								APPROVED 核准	譚宏	DWG NO. 圖號	PE1903A						